



PARTS LIST FOR MODEL  
FATHOM 30 LD2 LH  
REEL PART NO. 1422245

Key No.	Part No.	PENN Style No.	Description
1	1408157	1-FTH30LD2LH	Left Side Plate Assembly
ID	1408158	ID-FTH25NLD2LH	Bridge
2	1408159	2-FTH25NLD2LHSMK	Quadrant (Gun Smoke)
2A	1408160	2A-FTH25NLD2LH	Drag Lever Ratchet
4	1264978	4-TRQ15LD2	Lever Washer
5H	1408162	5-FTH25NLD2LHHS	Main Gear High Speed
5L	1408161	5-FTH25NLD2LHLS	Main Gear Low Speed
8	1257843	8-30SLD	Spring Washer
13B	1309868	13B-FTH30LD2	Sleeve Spindle
13H	1408164	13-FTH25NLD2LHHS	High Speed Pinion
13L	1408163	13-FTH25NLD2LHLS	Low Speed Pinion
14	1181406	14-535	Spring-Dog
15	1229374	15-TRQ40	Dog Asm (2 req)
16	1188686	16-20	Bridge Screw (2 req)
18	1265001	18-TRQ40NLD2	Spring Washer (2 req)
18C	1181632	18C-15KG	Spring Shift Button (2 req)
18H	1265002	18H-30SLD2	Spring
18L	1265003	18L-30SLD2	Spring

Key No.	Part No.	PENN Style No.	Description
19	1408165	19-FTH25NLD2LH	Drag Cam
21	1265007	21-TRQ30LD2SMK	Lever Drag (Gun Smoke)
21A	1265011	21A-TRQ30LD2	Lever Quadrant Spacer
23	1229458	23-12VS	Screw, Handle Nut
23L	1191283	23L-750	Screw
23W	1286986	23W-TRQ40NLD2	Handle Nut Washer
24	1277510	24-TRQ30LD2SMK	Handle Assembly (Gun Smoke / Gold)
24C	1191335	24C-66	Cap- Handle Knob
25	1240293	25-TRQ40	Knob Handle Molded
26	1265023	26-TRQ40NLD2	Ball Bearing
26N	1182145	26N-25	Bearing- Ball
27	1408167	27-FTH30LD2LH	Right Side Plate Assembly
29	1309878	29-FTH30LD2	Spool (Gun Smoke / Gold)
32	1265049	32-TRQ15LD2S	Screw
33	1290729	33-TRQ	Rod Clamp Aluminum
33C	1290731	33C-TRQ40NLD2	Rod Clamp Kit

Key No.	Part No.	PENN Style No.	Description
34	1182788	34-45	Screw, Rod Clamp (2 req)
35	1188656	35-20	Click Tongue
36	1242796	36-FTHSD12	Click Button
36A	1208113	36A-FTH20LW	Click Washer
36B	1188651	36B-20	Washer
38	1309885	38-FTH15LD2	Screw (8 req)
38A	1188649	38A-20	Flat Washer (8 req)
38B	1265055	38-TRQ40NLD2S	Screw (2 req)
41	1265056	41-TRQ40NLD2	Drag Disengaging Spring
46A	1507714	46A-FTH15LD2	Cover Plate Screw (2 req)
50	1309888	50-FTH30LD2	Shield, Guard
55A	1238912	55A-50SLD	Ball Bearing
55L	1286985	55L-20	Ball Bearing (2 req)
55T	1238913	55T-30SLD	Thrust Bearing
62	1188664	62-20	Click Spring
62A	1188653	62A-20	Click Spring Guard
62B	1236596	62-TRQ40	Spring Click Locator
62C	1188654	62C-20	Screw (7 req)
66A	1265059	66A-FTHLD	Click Gear
67	1184105	67-30VS	Ring Retaining
69	1188657	69-20	Retainer (3 req)
69D	1265060	69D-FTH15LD	Retaining Ring
71	1309892	71-FTH30LD2	Spindle Complete
82	1265070	82-TRQ40NLD2	Washer Teflon (2 req)
82A	1265071	82A-30SLD2	Washer Teflon
91A	1277514	91A-TRQ40NLD2	Handle Knob Washer
98	1265073	98-FTH40NLD2	Ratchet
110A	1230438	110A-12VS	Ring, Handle Screw Locking
110B	1265074	110B-TRQ40NLD2B	Base Assembled Black
110C	1265075	110C-12VSB	Retainer Shift Button Black
110D	1309895	110D-FTH15LD2	Retaining Ring
117	1309896	117-FTH15LD2	Drive Plate
117A	1309898	117A-FTH25NLD2	Drag Washer (Assembly)
117W	1309901	117W-FTH25NLD2	Drag Washer Metal
128	1265084	128-30SLD2	Shift Key
133	1230583	133-12VS	Plate Retaining
134	1265085	134-30SLD2	Gear Stud
134A	1265086	134A-30SLD2	Nut Gear Stud
134B	1265087	134B-30SLD2	Washer Support Gear Stud
141	1265088	141-TRQ15LD2	Cam Follower
141B	1265089	141B-TRQ15LD2	Preset Knob Click Spring
144	1265090	144-TRQ15LD2B	Preset Knob (Black)
149	1184702	149-45	Rod Clamp Nut (2 req)
149A	1184706	149-200	Hex Nut (2 req)
154	1265092	154-TRQ40NLD2	Gear Stud Shim (As Required)
154A	1306668	154A-TRQ40NLD2	Gear Stud Shim (As Required)
154B	1309903	154B-FTH25NLD2	Belle ville Distance Washer (1req)
154B	1309904	154B-FTH40NLD2	Belle ville Distance Washer (1req)
161	1265097	161-TRQ40NLD2	Locating Button
161A	1265098	161A-TRQ15LD2	Lever Click Pin
161B	1265099	161B-TRQ40NLD2	Strike Button
162	1318280	162-TRQ40NLD2	Spring
171	1265101	171-30SLD2	Plunger Gear Shift
172	1265102	172-12VSB	Shift Button Assembly Black
172B	1184831	172B-30VS	Spacer
173	1192384	173-12VS	Catch, Shifter (2 req)
173A	1230664	173A-12VS	Holder Catch
183	1408169	183-FTH30LD2LH	Frame Assembly
195	1184955	195-40	Retaining Ring (2 req)

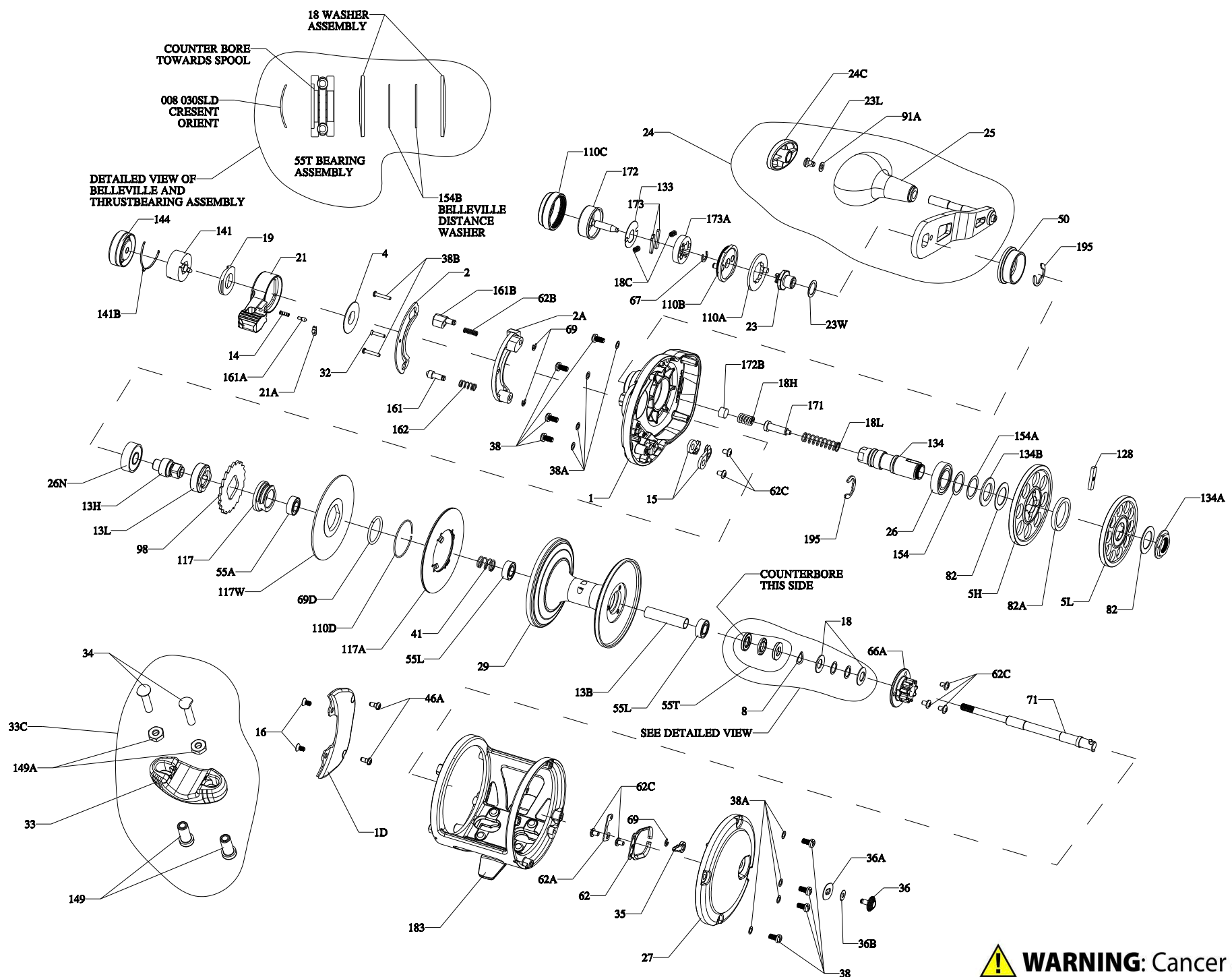

**WARNING:** Cancer and Reproductive Harm – [www.P65Warnings.ca.gov/products](http://www.P65Warnings.ca.gov/products)